

深圳市鑫美芝实业有限公司

ShenZhen XinMeiZhi INDUSTRY CO.,LTD

RHL1828A-05
BL-JLX12848G-942
LED BACKLIGHT
FOR LCD DISPLAY

1. 结构尺寸 MECHANICAL OUTLINE

(未注尺寸公差:specified Tolerances is:) .xx ± 0.2
.x ± 0.2

COLOR : WHITE
颜色 : 白色

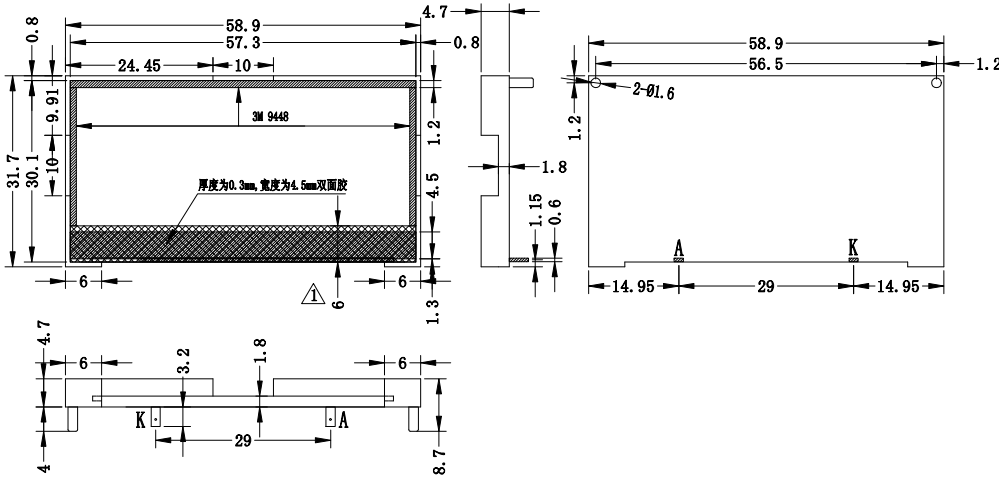

2. 电路图 CIRCUIT DIAGRAM (LED)

djes)

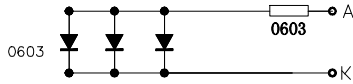

NOTE:
1. (.) REFERENCE DIMENSION.
2. ▽ SPECIAL CHARACTERISTIC.

注意防静电

3. 保存和焊接条件 STORAGE & SOLDERING CONDITIONS:

• Store with care. Storing the units in bad condition will cause the reflector sheet and decrease its adhesive power. Storage The products under the condition: temperature (25°C ±10°C) and humidity (65%RH±20%RH) our recommendation.

• 注意保存. 保存条件不好时会降低反光膜(扩散膜)与导光片(反射壳)的粘附力
推荐保存条件为: 温度 25°C±10°C
湿度 65%RH±20%RH

ISSUE 标识	AMENDMENT 改正内容	Date: 日期	DESIGN: 设计
▲	遮光区宽度增加0.5mm	20.9.8	CHECKED: 检查
			COUNTERSIGN: 会签
			APPROVED: 批准

Drawing No: 图号: RHL1828.2.01 REV: 版本 A1

深圳市鑫美芝实业有限公司

ShenZhen XinMeiZhi INDUSTRY CO.,LTD

RHL1828A-05
BL-JLX12848G-942
LED BACKLIGHT
FOR LCD DISPLAY

- The Soldering Temperature is 260±5°C and Soldering Time should be less than 3 sec, and soldering iron power should be less than 30W.
- The soldering point should be farther than 1.6mm from body .
- 焊接温度 260°C±5°C, 焊接时间小于3秒
烙铁功率小于30W.
- 焊接点应离产品实体大于1.6mm .

4. 极限参数 ABSOLUTE MAXIMUM RATINGS

(除非特别说明, 环境温度 Ta=25°C,specified,The Ambient temperature Ta=25°C)

项目 Item	符号 Symbol	条件 Conditions	值 Rating	单位 Unit
* 极限直流正向电流 Absolute maximum forward current	Ifm		25*3	mA
* 脉冲驱动时极限正向电流 Peak forward current	Ifp	1 msec 脉冲,1/10 占空比 1 msec Plus 10% Duty Cycle	75*3	mA
反向电压 Reverse Voltage	Vr		5.0	v
* 极限功耗 Power dissipation	Pd		80*3	mW
工作温度 Operating Temperature Range	Topr		-20~+70	°C
贮存温度 Storage Temperature Range	Tstg		-30~+80	°C

5. 电·光特性 ELECTRICAL-OPTICAL CHARACTERISTICS

(除非特别说明, 环境温度 Ta=25°C,specified,The Ambient temperature Ta=25°C)

项目 Item	符号 Symbol	最小值 min.	典型值 typ.	最大值 max.	单位 Unit	测定条件 Condition
正向电压 Forward Voltage	Vf	2.8	3.0	3.2	V	If= 45mA
反向电流 Reverse Current	Ir			30	μA	Vr= 5.0 V
主波长 Dominant wave length	λD	X: 0.25-0.31 Y: 0.25-0.31			nm	If= 45mA
频谱半宽度 Spectral Line Half width	Δλ				nm	If= 45mA
* 亮度 Luminance	Lv		TBD		cd/m ²	If= 45mA

*亮度值是5个测量点的平均值, 亮度最小值比最大值一般大于75%
使用BM-7 亮度色度仪测量, 测量光圈 φ 5 mm. 工作寿命=50000小时
The luminance is the average value of points, and 5
The Lvmin./Lvmax. is more than Typical 75%
The measurement instrument is BM-7 luminance Colorimeter.The aperture is φ mm. 5 lifetime=50000h

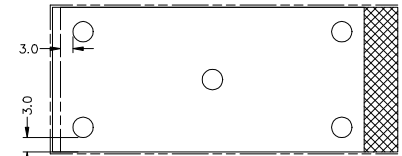

Drawing No: 图号: RHL1828.2.01 REV: 版本 A1 STAMP 确认